

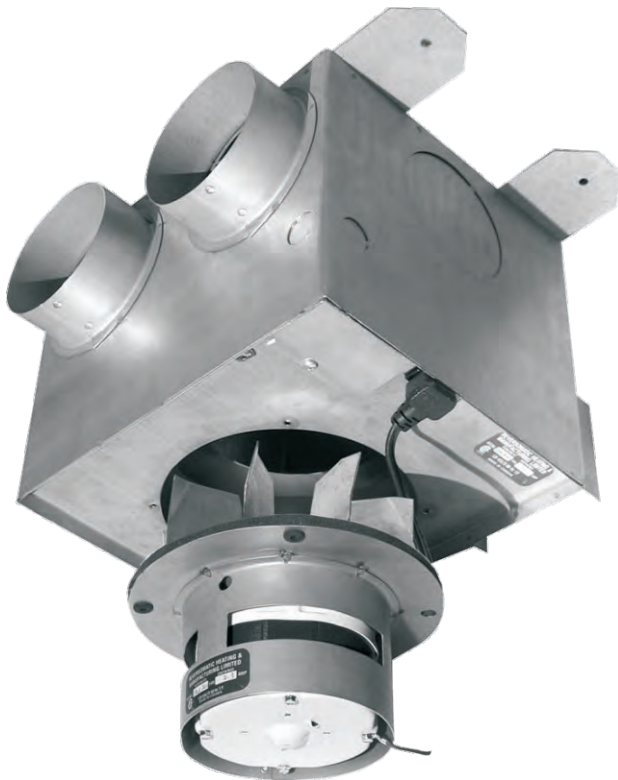

COMBINATION IN-LINE EXHAUST FAN

The DBP-300 is especially designed to exhaust the air from a combination of bathrooms. It is equipped with a paddle wheel impeller. The fan is available with two or three inlets.



DBP-300 FAN DATA (2 INLET & 3 INLET)

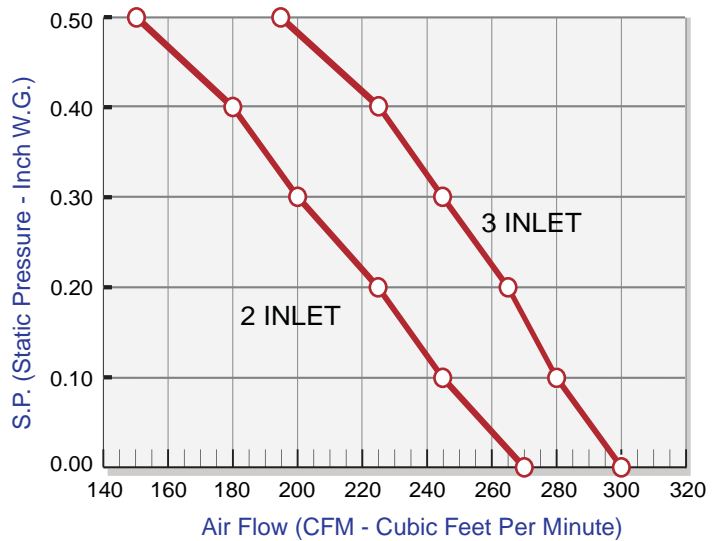

ACCESSORIES

Standard:

- Neoprene Dampers (Inlet side)
- Mounting Brackets

Optional:

- Balance Box
- Outlet Transition
- Lint Trap
- Access Door
- Speed Controller

*Minimum CFM for ventilation and/or interconnections of ducts and fans could be regulated by your local by-laws. Verify acceptance of installation when necessary.



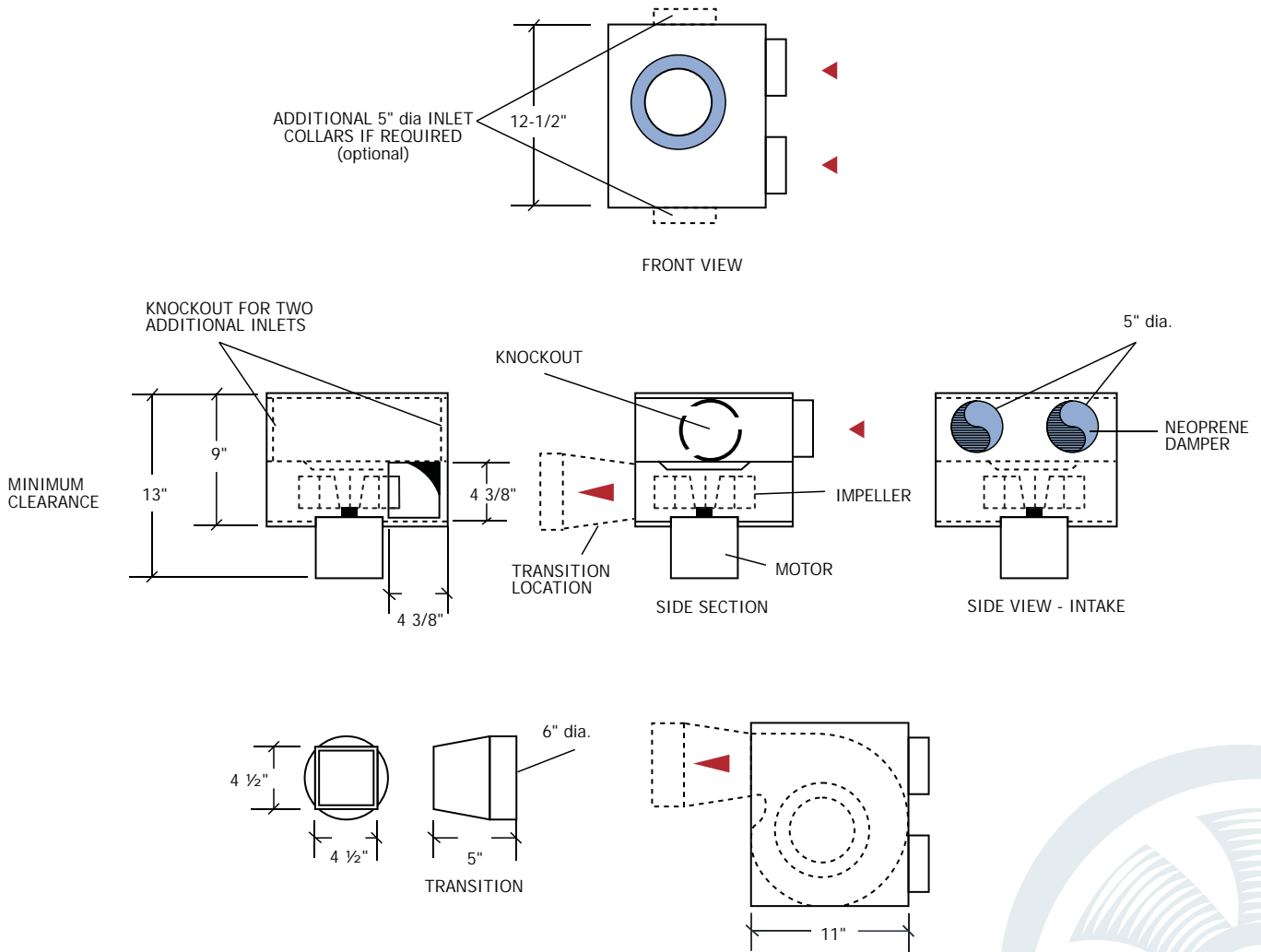

FAN DATA

MODEL	MOTOR 120 VAC 60Hz			CUBIC FEET PER MINUTE					
	RPM	AMPS	S.P.	0.00	0.10	0.20	0.30	0.40	0.50
DBP300	1550	2.9	CFM 2 INLET	270	245	225	200	180	150
			CFM 3 INLET	300	280	265	245	225	195

RPM (Revolution Per Minute) shown is nominal and performance is based on actual speed of test.

Contractor:		DBP-300		
Architect:	Job:	Date	Supersedes	Drawing No.
Engineer:	Date Submitted:			

Reversomatic Manufacturing Ltd.